

TECHNICAL MEMORANDUM 003 ACCEPTABLE POSITIONS FOR DAMP PROOF COURSES IN EXTERNAL WALLS

The diagram below shows typical examples of the position of damp proof courses fitted in external walls of buildings which we would find to be acceptable

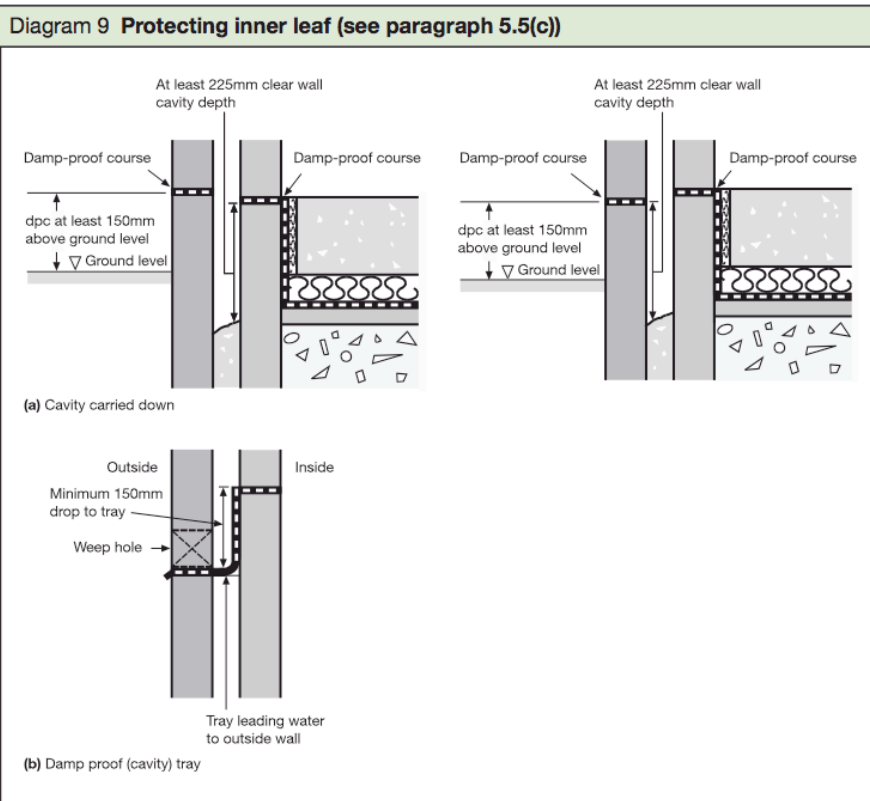
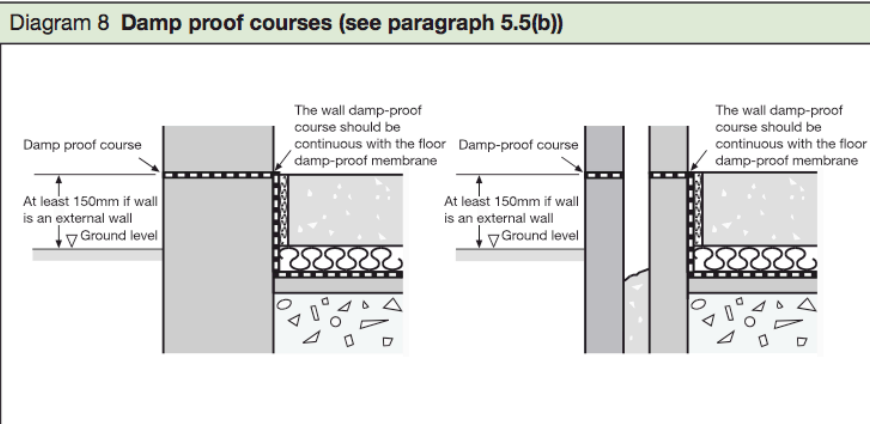

References in this diagram are contained with Approved Document Part C

Building Control Surveyors Ltd (Corporate Approved Inspectors)

Construction Industry Council No: 156

Corporate Administration Offices: Building Control, Warlies Park House, Teulon Wing, Horseshoe Hill, Upshire, Essex EN9 3SL

Tel: 01992 710 763 Email: support@bcsvr.com Web: www.bcsurv.com